

HDPE  
Blind Flange, IPS  
ANSI B16.5, B16.47 and AWWA C207

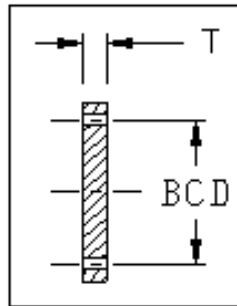

Dimensions and weights are approximate and subject to change. Please call for sizes not listed.

IPS Pipe Size	Nominal OD (in)	Dimension (in)		Weight (lbs)	Bolt	
		BCD	T		Diameter	Number
2"	2.375	4¾	1	2	5/8	4
3"	3.500	6	1	2	5/8	4
4"	4.500	7½	1½	3	5/8	8
6"	6.625	9½	1½	4	¾	8
8"	8.625	11¾	1½	6	¾	8
10"	10.750	14¾	2	9	7/8	12
12"	12.750	17	2	13	7/8	12

These Blind Flanges are ordinarily used for closure or night-capping of flanged pipes.

Low Pressure - they are NOT fully pressure rated.

Without the use of a metal back-up blind flange, the HDPE may leak between bolt-holes at moderate pressures. Always use metal washers.

Revised 02/23/2017

<i>San Francisco</i>	<i>511 Tunnel Avenue, Brisbane, CA 94005</i>	<i>415-467-4630</i>	<i>FAX 415-467-1010</i>
<i>Los Angeles</i>	<i>1304 E. San Bernardino Ave., San Bernardino, CA 92408</i>	<i>909-799-7800</i>	<i>FAX 909-799-5558</i>
<i>Bakersfield</i>	<i>4039-C Well Tech Way, Bakersfield, CA 93308</i>	<i>661-589-7300</i>	<i>FAX 661-589-7377</i>
<i>Reno</i>	<i>675-B Edison Way, Reno, NV 89502</i>	<i>775-856-1888</i>	<i>FAX 775-856-1844</i>