

HDPE PE4710
Flange Adapter, IPS
AWWA C901 or C906

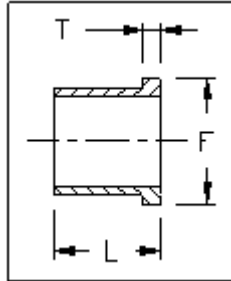

Dimensions and weights are approximate and subject to change. Please call for sizes not listed.

IPS Pipe Size	Nominal OD (in)	Dimension Ratio (DR)	Dimension (in)			Weight (lbs)
			L	F	T	
1"	1.315	17	4	2 ³ / ₈	3 ³ / ₈	0.1
		11				
1 ¹ / ₄ "	1.660	17	4	2 ³ / ₄	3 ³ / ₈	0.2
		11				
1 ¹ / ₂ "	1.900	17	6	3 ¹ / ₈	3 ³ / ₈	0.2
		11				
2"	2.375	17	6	3 ³ / ₄	5 ⁵ / ₁₆	0.5
		11			1 ¹ / ₂	
3"	3.500	17	6	4 ⁵ / ₈	7 ⁷ / ₁₆	1.5
		11			11 ¹¹ / ₁₆	
4"	4.500	17	7	6	9 ⁹ / ₁₆	2
		11			13 ¹³ / ₁₆	
6"	6.625	17	8	8 ¹ / ₈	3 ³ / ₄	4
		11			1 ³ / ₁₆	
8"	8.625	17	11	10 ³ / ₈	1	9
		11			1 ¹ / ₂	
10"	10.750	17	12	12 ³ / ₄	1 ¹ / ₄	11
		11			1 ⁷ / ₈	
12"	12.750	17	12	15 ¹ / ₂	1 ⁷ / ₁₆	17
		11			2 ³ / ₁₆	
14"	14.000	17	12	17	1 ¹ / ₂	26
		11			2 ³ / ₈	

Revised 02/23/2017

San Francisco	511 Tunnel Avenue, Brisbane, CA 94005	415-467-4630	FAX 415-467-1010
Los Angeles	1304 E. San Bernardino Ave., San Bernardino, CA 92408	909-799-7800	FAX 909-799-5558
Bakersfield	4039-C Well Tech Way, Bakersfield, CA 93308	661-589-7300	FAX 661-589-7377
Reno	675-B Edison Way, Reno, NV 89502	775-856-1888	FAX 775-856-1844

HDPE PE4710
Flange Adapter, IPS
AWWA C901 or C906

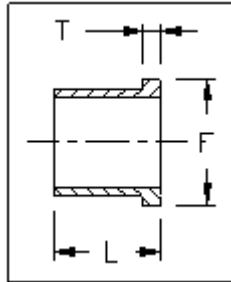

Dimensions and weights are approximate and subject to change. Please call for sizes not listed.

IPS Pipe Size	Nominal OD (in)	Dimension Ratio (DR)	Dimension (in)			Weight (lbs)
			L	F	T	
16"	16.000	17	12	19½	1 ¹³ / ₁₆	33
		11			2¾	
18"	18.000	17	12	20⅞	2	41
		11			3	
20"	20.000	17	12	23¼	2⅞	56
		11				
22"	22.000	17	12	25¼	2⅞	68
		11				
24"	24.000	17	12	27¾	2⅞	83
		11				
26"	26.000	17	14	29¾	2⅞	90
		11				
28"	28.000	17	14	32	3	95
		11				
30"	30.000	17	14	34	3¼	108
		11				
32"	32.000	17	14	36½	3½	124
		11				
34"	34.000	17	14	38⅞	3⅞	108
		11				
36"	36.000	17	14	40½	3⅞	159
		11				210
42"	42.000	17	21	47⅞	3¾	238
		11				306
48"	48.000	17	21	53½	3⅞	316
		11				405
54"	54.000	17	21	59⅞	3¾	370

Revised 02/23/2017

San Francisco	511 Tunnel Avenue, Brisbane, CA 94005	415-467-4630	FAX 415-467-1010
Los Angeles	1304 E. San Bernardino Ave., San Bernardino, CA 92408	909-799-7800	FAX 909-799-5558
Bakersfield	4039-C Well Tech Way, Bakersfield, CA 93308	661-589-7300	FAX 661-589-7377
Reno	675-B Edison Way, Reno, NV 89502	775-856-1888	FAX 775-856-1844