

HDPE
Cross, IPS
AWWA C901 or C906

Style 1

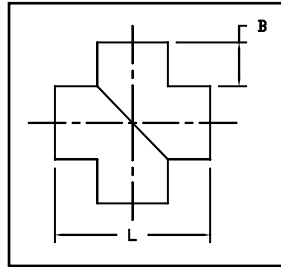

Style 2

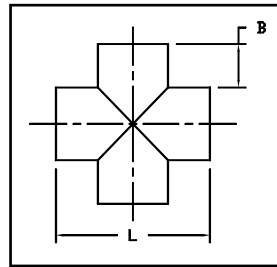

Dimensions and weights are approximate and subject to change. Please call for sizes not listed.

IPS Pipe Size	Nominal OD (in)	Pressure Rating	Feed Stock	Style	Dimension (in)		Weight (Lbs)
					L	B	
2"	2.375*	100	-	1	10 1/4	3 7/8	2
		160	-				3
3"	3.500*	100	-	1	11 3/8	4	3
		160	-				4
4"	4.500*	100	-	1	12 1/2	4	4
		160	-				6
6"	6.625*	100	-	1	16 5/8	5	12
		160	-				17
8"	8.625*	100	-	1	24 1/8	7 3/4	19
		160	-				42
10"	10.750*	80	DR 17	2	23 3/4	6 1/2	42
		128	DR 11				62
12"	12.750*	80	DR 17	2	27 3/4	8	69
		128	DR 11				98
14"	14.000*	80	DR 17	2	30	8	85
		128	DR 11				121
16"	16.000*	80	DR 17	2	32	8	116
		128	DR 11				166
18"	18.000*	80	DR 17	2	46	14	226
		128	DR 11				322
20"	20.000*	80	DR 17	2	48	14	288
		128	DR 11				409
22"	22.000*	80	DR 17	2	50	14	275
		128	DR 11				393
24"	24.000*	80	DR 17	2	52	14	433
		128	DR 11				620

* Meets AWWA

San Francisco	511 Tunnel Avenue, Brisbane, CA 94005	415-467-4630	FAX 415-467-1010
Los Angeles	1304 E. San Bernardino Ave., San Bernardino, CA 92408	909-799-7800	FAX 909-799-5558
Bakersfield	5221 Gilmore Ave., Bakersfield, CA 93308	661-326-7800	FAX 661-326-7805
Reno	675-B Edison Way, Reno, NV 89502	775-856-1888	FAX 775-856-1844